

1625nm 5mW Pigtailed Laser Module with Polarization maintaining Fiber (PM Fiber)

1625nm PM Fiber Coupled LD Module with Coaxial Package (9um Single Mode PM Fiber)

WSLP-1625-005m-PM-DFB

Wavespectrum Laser Group

www.wavespectrum-laser.com

PARAMETER	SYMBOL	VALUE	UNIT	
LD Reverse Voltage	V_r	2.0	V	
PD Reverse Voltage	$V_{r(PD)}$	15	V	
Operating Temperature	T_{op}	-20~+50	°C	
Storage Temperature	T_{stg}	-40~+100	°C	
Lead soldering temperature (10 sec.)	T_{is}	260	°C	
Features: <ul style="list-style-type: none"> ● 1625nm ● DFB Laser Diode ● Built-in Photodiodes ● Built-in Isolator ● High Reliability ● High Polarization Extinction Ratio 				
Applications: <ul style="list-style-type: none"> ● Test Equipments ● Optical Transmitter of Analog Signal ● Optical Transmitter of Data Signal 				
Specifications		WSLP-1625-005m-PM-DFB		
		Min	Type	Max
Center Wavelength@25°C		±3nm	1625nm	±10nm
Spectral Width(FWHM)		----	0.3nm	1nm
Output Power		----	5mW	----
Fiber Type	Polarization Maintaining Fiber			
Fiber Core	9um			
Recommended Operation Temperature	25°C			
Polarization Extinction Ratio	13dB	15dB	----	
Connector	FC/APC			
Threshold Current (Typ.) I_{th}	----	5mA	15mA	
Operating Current	----	80mA	90mA	
Operating Voltage	----	1.4V	1.7V	
Optical Isolation	30dB			
Fiber Length	>80cm			
Package Style	Coaxial or B86			
High Polarization Extinction Ratio (PER) Version Laser Module is also available, please contact us.				



Coaxial Package View: (Part Number: WSLP-1625-005m-PM-DFB)

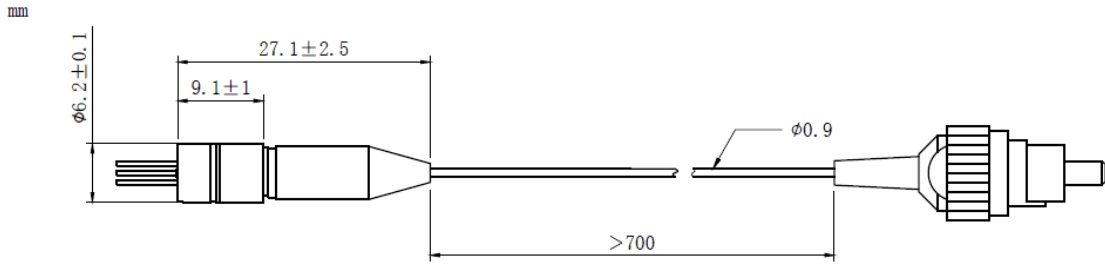

B86 Package View: (Part Number: WSLP-1625-005m-PM-B-DFB)

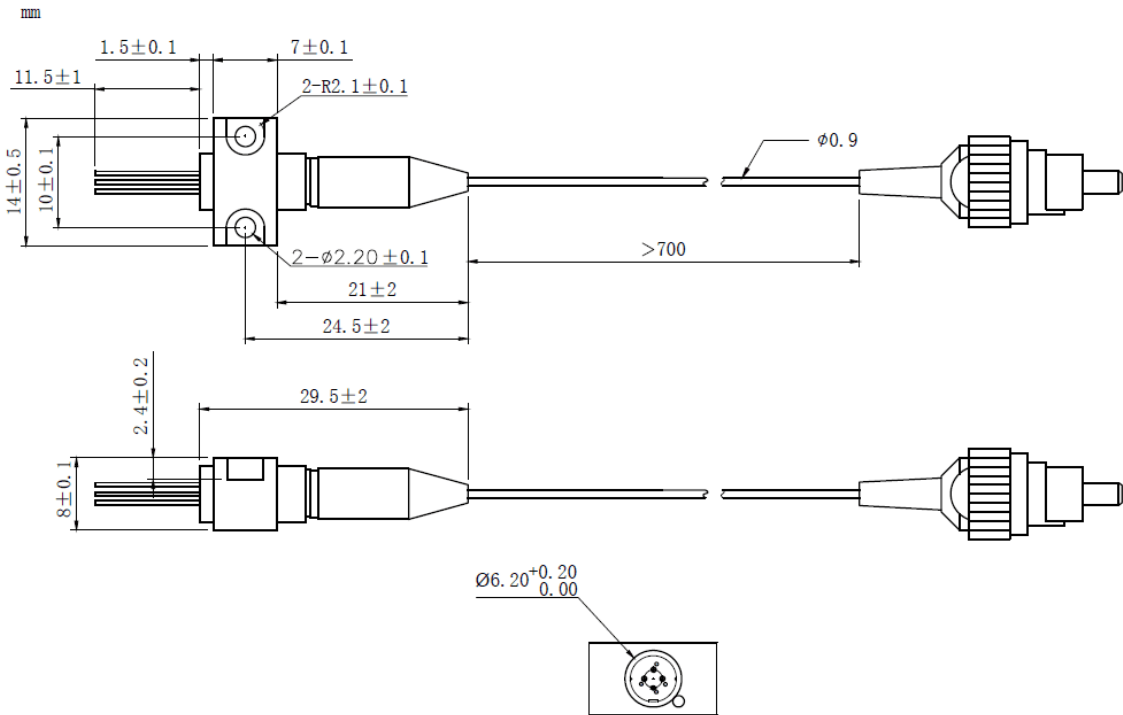

Bottom View: (A-Type)

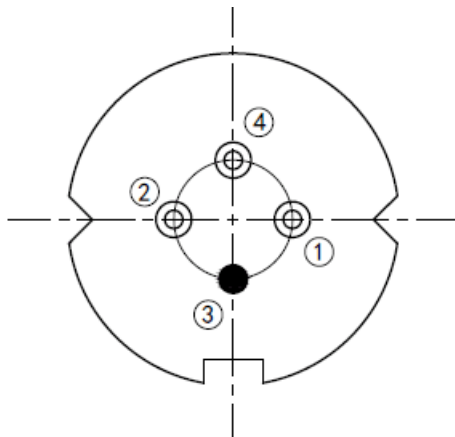

PIN 1	PD (+)
PIN 2	LD (-)
PIN 3	LD (+), CASE
PIN 4	PD (-)



**Electrically shorten LD module and store in non-extreme conditions.
Suggest using the constant current power supply.**

